

SQUARE TUBE

TUBE CARRÉ

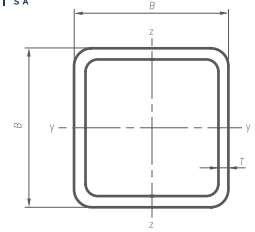

Precision Tube (EN 10305-5) Structural Tube (EN 10219) Tube Précision (EN 10305-5) Tube Structurel (EN 10219)																	
BxB Side dim. Dim. latérale	Cold Rolled Laminé à Froid					Sendzimir Galvanized Galvanisé Sendzimir						Hot Rolled Laminé à Chaud					Un. Uni. Tied Attaché
	Thickness/Épaisseur – T (mm) Theoretical Weight/Poids Théorique (kg/m)					Thickness/Épaisseur – T (mm) Theoretical Weight/Poids Théorique (kg/m)						Thickness/Épaisseur – T (mm) Theoretical Weight/Poids Théorique (kg/m)					
mm	0,80	1,00	1,25	1,50	2,00	1,00	1,25	1,50	2,00	2,50	3,00	1,50	2,00	2,50	3,00	4,00	
20x20	0,477	0,592	0,732	0,869	1,134	0,592	0,732	0,869	1,134	1,387	-	0,869	1,134	-	-	-	320
25x25	0,616	0,765	0,948	1,128	1,48	0,765	0,948	1,128	1,48	1,819	2,146	1,128	1,48	1,819	2,146	-	252
25,4x25,4	0,616	0,765	0,948	1,128	1,48	0,765	0,948	1,128	1,48	1,819	2,146	1,128	1,48	1,819	2,146	-	252
30x30	-	0,912	1,133	1,35	1,776	0,912	1,133	1,35	1,776	2,189	2,589	1,35	1,776	2,189	2,589	-	196
35x35	-	1,085	1,349	1,609	2,121	1,085	1,349	1,609	2,121	2,62	3,107	1,609	2,121	2,62	3,107	-	168
38x38	-	1,159	1,441	1,72	2,269	1,159	1,441	1,72	2,269	2,805	3,329	1,72	2,269	2,805	3,329	-	144
40x40	-	1,208	1,503	1,794	2,368	1,208	1,503	1,794	2,368	2,929	3,477	1,794	2,368	2,929	3,477	4,538	144
45x45	-	-	1,719	2,053	2,713	-	1,719	2,053	2,713	3,36	3,995	2,053	2,713	3,36	3,995	5,228	100
50x50	-	-	1,919	2,294	3,033	-	1,919	2,294	3,033	3,761	4,476	2,294	3,033	3,761	4,476	5,869	81
50,8x50,8	-	-	1,919	2,294	3,033	-	1,919	2,294	3,033	3,761	4,476	2,294	3,033	3,761	4,476	5,869	81
60x60	-	-	-	2,76	3,655	-	-	2,76	3,655	4,538	5,408	2,76	3,655	4,538	5,408	7,112	63
63,5x63,5	-	-	-	2,904	3,847	-	-	2,904	3,847	4,778	5,697	2,904	3,847	4,778	5,697	7,497	64
70x70	-	-	-	3,233	4,286	-	-	-	4,286	5,327	6,355	3,233	4,286	5,327	6,355	8,375	56
76,1x76,1	-	-	-	3,533	4,686	-	-	-	4,686	5,826	6,955	4,686	5,826	6,955	9,174		49
80x80	-	-	-	3,662	4,858	-	-	-	4,858	6,042	7,213	4,858	6,042	7,213	9,519		49
88,9x88,9	-	-	-	-	-	-	-	-	5,539	6,893	8,234	5,539	6,893	8,234	10,881		36
90x90	-	-	-	-	-	-	-	-	5,539	6,893	8,234	5,539	6,893	8,234	10,881		36
100x100	-	-	-	-	-	-	-	-	6,165	7,676	9,174	6,165	7,676	9,174	12,133		36

Structural tube provided in steels S235JR, S275J0, S275J2, S355J0 and S355J2. Tube structurel fourni en acier S235JR, S275J0, S275J2, S355J0 et S355J2.